

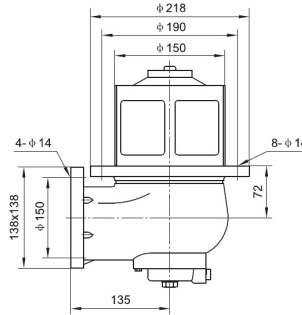

Flowtech

Pneumatic Bottom Valve Series

Pneumatic Bottom Valve **C804CQ-100**



Shear Groove



Air Cylinder



Fusible Element & Emergency Opening



Matching Flange

Function & Feature

1. Air cylinder can be dismantled independently, it is convenient for maintain.
2. It can be opened by manual way, when pneumatic is not available or air supply failure.
3. Aluminum surface deal with oxidation treatment.
4. Conform to european standard and get the ADR certificates.

Bottom Valve **Introduction**

It install on the bottom of the tanker with the disc sealed inside it. Valve body with self-cut groove. When in the event of accidental damage, the external housing will break away from the self-cut groove, keeping the connection to the valve tank mounting flange, leaving the bottom valve sealing mechanism within the tank compartment intact, efficiently protecting the tanker from leakage, ensuring the safety of transportation. It is suitable for water, diesel, petrol and other light fuel.

Function & Feature

- **Special surface treatment**  
Aluminum alloy surface is treated by oxidation to improve the anti-corrosion.
- **Large Flow**  
Reasonable fluid mechanics design to ensure large flow of input and output.
- **Emergency shut off**  
When hit with a strong force, the valve body will break down along the shear groove, to keep the tanker sealed.
- **Mechanical Switch**  
When pneumatic switch can not be opened, it can open by mechanical switch
- **Automatically closed**  
When the temperature rise  $75^{\circ}\text{C} \pm 5^{\circ}\text{C}$ , during the working, it can automatically closed with fusible element.

Technical Data

Nominal diameter	4"
Nominal Pressure	0.6MPa
Material	Aluminum alloy
Flow rate	2,500 Lpm
Installation	Flanged
Open method	Pneumatic
Temperature range	20~+50